



EXPLORER CLIMBING PANELS

INSTALLATION, OPERATION,
& MAINTENANCE MANUAL



WARNING – Improper assembly or use of this product and the activity of climbing and bouldering have risks that can lead to injury, paralysis, and even death. Read these instructions and warnings before assembly, installation, and use!

CONTACT US
shop@grohplayrooms.com

FIND MORE RESOURCES AT
shopgrohplayrooms.com

SAFETY INFORMATION

READ BEFORE INSTALLATION AND USE



FAILURE BY THE USER TO HEED ANY AND ALL INSTRUCTIONS, WARNINGS AND CAUTIONS FOR THE CORRECT INSTALLATION, OPERATION, CARE, AND MAINTENANCE OF CLIMBING PRODUCTS MAY RESULT IN SERIOUS INJURY OR DEATH.

The grOH! Shop's climbing and gross motor play products are designed and specified for recreational climbing as a self-installable climbing product. Use of equipment for any purposes other than that intended by the manufacturer is not recommended. The Climbing Panel must never be installed onto any surface other than those specified within this manual.

Owners and users of any climbing/gross motor products purchased from The grOH! Shop are responsible for the safety and supervision of any person using the product and for ensuring proper installation and operation procedures are followed at all times. Proper installation requires careful planning and fastener placement on the Climbing Panel and associated components, including the supporting wall's structural elements. Owners and users are highly encouraged to have an experienced, licensed, and insured general contractor install all gross motor features, including climbing panels.

It is the responsibility of the installer to verify existing walls meet the minimum structural requirements listed in this document and are of sound construction without any defects. The grOH! Shop is not responsible for verifying the structure for climbing panel attachment.

Installation of our products is the responsibility of the customer, who assumes any liability for damage to property or injury. While every attempt is made to embody the highest degree of protection in all equipment, we cannot, however, guarantee freedom from injury. The user assumes all risk of injury due to use. All merchandise is sold on this condition, which no representative of the company can waive or change. Equipment should be inspected periodically by user for damage and wear and tested for stability.

The Climbing Panel is designed to be used for bouldering, a style of free-climbing without a belay, and in conjunction with adequate engineered fall attenuation surfaces. No component of the Climbing Panel is appropriate for use as part of an anchor or belay system.

Should roped-climbing be desired, an engineered rope belay mount and/ or auto belay mount is strictly required. Owners and users are responsible for the proper installation and use of these belay systems at all times.

Please note: Brick is NOT an acceptable mounting surface for any mounting method outlined in this manual.

SAFETY INFORMATION

READ BEFORE INSTALLATION AND USE



WARNING- CLIMBING IS A DANGEROUS ACTIVITY

Climbing is inherently dangerous and may result in serious injury or death of a participant. The Explorer Climbing Panels is designed and specified for recreational climbing as an indoor-only self-installable climbing wall product which can be mounted on any appropriate support structure that meets its loading specifications including Concrete Masonry Unit (CMU), Concrete, Metal Studs, and Wood Studs. Brick is NOT an acceptable attachment structure.

Users of the Explorer Climbing Panels are solely responsible for learning, implementing, and conveying to participants proper climbing techniques, including falling and good judgment. This includes knowing and observing the product's capabilities and limitations and ensuring the climbing area is free and clear from all obstructions including, but not limited to: furniture, protrusions, structures, or other objects, climbers, or observers. Users must be aware of all necessary precautions and dangers and must educate all participants in the proper use of the Explorer Climbing Panel as well as all third-party equipment such as modular handholds and fall attenuation padding.

The Explorer Climbing Panel is designed to be used for bouldering, a style of free-climbing without a belay, and in conjunction with adequate engineered fall attenuation surfaces.

No component of the Explorer Climbing Panel is appropriate for use as part of an anchor or belay system. All anchors, belay systems and associated components must be suitable for use within a climbing system and must meet all applicable laws, regulations and standards. Owners and users are responsible for the proper installation and use of these belay systems at all times.

It is the responsibility of the installer to verify existing walls meet the minimum structural requirements listed in this document and are of sound construction without any defects. The grOH! Shop is not responsible for verifying the structure for climbing panel attachment. Seeking the advice of a qualified professional prior to installation and use is strongly recommended.

SYMBOLS EXPLAINED



ENSURE THAT YOU READ AND UNDERSTAND ALL SAFETY PROCEDURES

The following safety symbols are used throughout this manual to highlight potential dangers. One or more precautions may be associated with practices and procedures described within this manual. Failure to adhere to any precautions highlighted can result in death, serious injury, or equipment damage.



DANGER

Indicates a hazardous situation exists that, if not avoided, will result in serious injury or death.



WARNING

Indicates a potentially hazardous situation that, if not avoided, could result in serious injury or death.



CAUTION

Indicates a potentially hazardous situation that, if not avoided, may result in injury or equipment damage.

Please read the following statement and contact The grOH! Shop, in writing, if the intent of this document is unclear or questions arise. **YOU SHOULD NOT OPERATE THE PRODUCTS IN THIS MANUAL IF YOU DO NOT FULLY UNDERSTAND HOW TO OPERATE THEM SAFELY!**

This Manual contains information on the proper assembly, maintenance, and use of the Explorer Climbing Panel and includes all product warranty information. Ensure that this manual is readily available to users at all times.

OPERATING INSTRUCTIONS

Users of the Explorer Climbing Panel are solely responsible for the safety and supervision of any person installing or using the product. This includes learning, practicing, and conveying to participants proper climbing techniques including falling. Ensure the climbing area is free and clear from all obstructions including but not limited to: furniture, protrusions, structures or other objects, and other climbers. Users must inform participants of all necessary precautions and dangers and must educate all participants in the proper use of the Explorer Climbing Panel as well as all third-party equipment such as modular handholds and fall attenuation padding.

Owners and users are to adhere to the following operating requirements:

- Climbers cannot exceed 270 lbs.
- Adult supervision is required by all users under 6 yrs.
- Proper fall technique is required.
- One (1) user at a time.
- Do not walk close to or behind a climber.
- Do not jump or swing from the panels.
- Do not attach any item to the panel (including volumes) other than bolt-on modular handholds or approved The groOH! Shop equipment.
- Do not use the equipment in a manner other than intended.



NEVER USE THE EXPLORER PANEL AS AN ANCHOR

Do not use any part of the Explorer Climbing Panel as an anchor component, including the T-Nuts. The components are not rated to be used as a personal anchor, belay anchor, lead bolt, etc.



ALWAYS USE APPROPRIATE FALL ATTENUATION SURFACE DURING USE

OPERATING INSTRUCTIONS

CONTINUED

The Explorer Climbing Panel and frame are required to be mounted with specific fasteners depending on the type of wall structure to which it is attached. Strictly adhere to the following procedures when installing the Explorer Climbing Panel:

- When attaching to stud walls (metal or wood), fasten the ledgers or mounting frame to studs with the specified structural screw at all points where the ledger or frame crosses a stud. Refer to the fastener schedule on page 12 of this document for proper attachment details.
- When attaching to CMU or concrete walls, refer to the fastener schedule on page 12 of this document for proper attachment details.
- All fasteners used to attach frames to walls must be set flush to or slightly recessed below the front face of the ledger or frame to ensure the Explorer Climbing Panel rests flush against the frame.
- It is recommended that two people perform the installation – one person to hold the frame or panel while the other fastens it.
- Never use any component of the Explorer Climbing Panel as an anchor or belay point.
- Never attach Explorer Climbing Panels to anything other than a vertical support structure, unless approved otherwise by a third party analyst. The groOH! Shop is not responsible for approving non-vertical support structures.



PROPER ATTACHMENT REQUIRED

Always refer to the fastener schedules in this document for proper attachment for your wall type. Brick is NOT an acceptable structure to attach to.



NEVER USE THE EXPLORER PANEL AS AN ANCHOR

Do not use any part of the Explorer Climbing Panel as an anchor component, including the T-Nuts. The components are not rated to be used as a personal anchor, belay anchor, lead bolt, etc.

MAINTENANCE INSTRUCTIONS

CARING FOR YOUR CLIMBING WALL

The Explorer Climbing Panel and mounting frames must be inspected and maintained every 30 days for proper attachment, secure panel attachment, and handhold bolt torque. This monthly inspection must be completed with the Explorer Climbing Panel and ledger secured in place to the structure. Owners or users with installations that receive heavy use may need to perform inspections more frequently.

Every 30 days:

- Clean any dust, dirt, or contamination off of the Explorer Climbing Panel and fasteners with a clean damp cloth.
- Visually inspect for separation between the frame and the wall.
- Visually inspect for separation between the Explorer Climbing Panel and the mounting frame.
- Visually inspect for splintering, de-lamination, or deterioration to the edge of the Explorer Climbing Panel.
- Tighten all modular handhold SHCS (bolts) to 12-13 ft lbs torque.



DO NOT USE SOLVENTS OR ABRASIVES
Clean with a cloth only. Do not use any cleaners, solvents, or abrasives on any part of the Explorer Climbing Panel or associated equipment.

PREPARATION FOR INSTALLATION

SELECTING A SUPPORT STRUCTURE

The mounting option for your Explorer Climbing Panel must attach to a vertical structure such as a metal or wood stud, concrete, or CMU wall. When selecting a location to install the Explorer Climbing Panel, always ensure:

- You have the specified fasteners for your particular supporting structure.
- The support structure is of sound construction and without any defects. The groOH! Shop is not responsible for verifying the structure.
- The climbing area is free and clear from all obstructions including, but not limited to: furniture, protrusions, structures or other objects.

SELECTING FASTENERS

OWNER MUST PURCHASE SPECIFIED STRUCTURAL SCREWS FOR THE CORRESPONDING WALL TYPE AND FOLLOW ALL INSTRUCTIONS PROVIDED BY THE MANUFACTURER. SEE CHARTS FOR THE FASTENER SPECIFIED FOR YOUR WALL TYPE.

BRICK IS NOT AN ACCEPTABLE ATTACHMENT STRUCTURE

IF FLAT HEAD FASTENERS ARE NOT AVAILABLE, COUNTERBORING OF THE LEDGER OR FRAME MAY BE REQUIRED TO ENSURE FLUSH FIT:

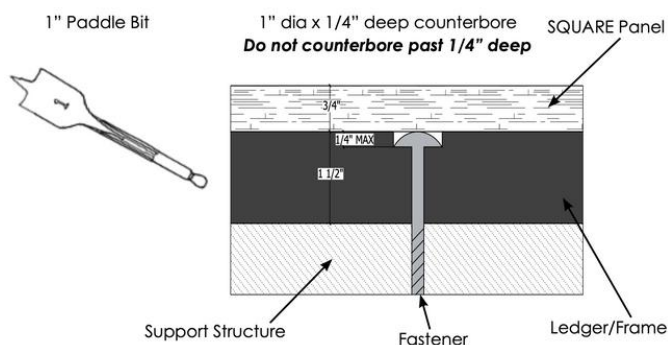

WALL TYPE & FASTENERS SCHEDULE



WALL TYPE: SOLID CONCRETE AND CMU (FULL GROUTED)

SPECIFIED FASTENER

1/4" Tapcon Hex Head
with 1-1/2" MIN embedment into wall

FASTENER QUANTITY PER PANEL

4 MINIMUM, DIRECT TO WALL

STRUCTURAL REQUIREMENT NOTES

$f'_c = 2,000$ psi min
Min CMU edge distance = 4"
Min Concrete edge distance = 3"
Recommended MIN CMU wall thickness = 8"
Recommended MIN Concrete wall thickness = 6"
Anchors shall NOT be installed in CMU mortar joints NOR cracked concrete

WALL TYPE: CMU (HOLLOW/UNGROUTED)

SPECIFIED FASTENER

1/4" Hilti Kwik-Con II Hex Head
with 1" MIN embedment into CMU face shell

FASTENER QUANTITY PER PANEL

4 MINIMUM, DIRECT TO WALL

STRUCTURAL REQUIREMENT NOTES

Lightweight, medium-weight or normal-weight ASTM C90
CMU Type
Min CMU edge distance = 4"
Recommended MIN CMU wall thickness = 8"
Anchors shall NOT be installed in CMU mortar joints

WALL TYPE & FASTENERS SCHEDULE



WALL TYPE: WOOD STUDS

SPECIFIED FASTENER

#14 (0.242" dia.) x 4" wood screw at each stud

FASTENER QUANTITY PER PANEL

4 MINIMUM, DIRECT TO WALL

STRUCTURAL REQUIREMENT NOTES

Screw bending yield strength = 70,000 psi (min)
Min screw head diameter = 0.50 in
Fasteners must be installed centered on narrow (1-1/2") face of stud
Recommended MAX 2x6 framed wall height = 10ft
Recommended MAX 2x4 framed wall height = 8ft

WALL TYPE: METAL STUDS

SPECIFIED FASTENER

#12-14 (0.216" dia.) Self Drilling Self Tapping (SDST) screw at each stud

FASTENER QUANTITY PER PANEL

4 MINIMUM, DIRECT TO WALL

STRUCTURAL REQUIREMENT NOTES

Screw bending yield strength = 92,000 psi (min)
Min screw head diameter = 0.398 in
Min thickness of steel stud = 18 gage (0.048")
Min width of steel stud flange = 1-5/8"
Fasteners must be installed centered on width of light gage steel stud
Recommended 8" deep stud framed @16", MAX wall height = 18ft
Recommended 6" deep stud framed @16", MAX wall height = 14ft
Recommended 4" deep stud framed @16", MAX wall height = 12ft

TOOLS & MATERIALS



TOOLS AND MATERIALS NEEDED FOR INSTALLATION (PROVIDED BY OWNER)

- Pencil
- Stud Finder
- Tape Measure
- Drill / Impact Driver
- 5/16" Allen Key
- Rapid Clamp (Optional)
- 1" Paddle Bit (if Flat Head fasteners are not available)
- Specified Structural Fasteners
- Bit for Structural Screws
- Star-Drive Bit
- Step Ladder
- Level
- Flat Outlet Cover & Electrical Wire Caps

EXPLORER PANEL AND MOUNTING HARDWARE (PROVIDED BY GROH!)

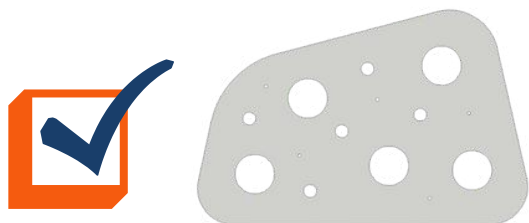

Explorer Climbing Panel x1
Mounting Frame x1



Panel Connector Screw x6
(TO ATTACH PANEL TO FRAME)

WARNING

ELECTRICAL OUTLETS

IF YOUR PANELS WILL BE IN FRONT OF AN ELECTRICAL OUTLET

Before installing your frames and your panels, you need to remove any electrical outlets that will be behind your wall.

IT IS A FIRE HAZARD TO LEAVE LIVE ELECTRICAL WIRES BEHIND YOUR CLIMBING PANELS.

Cap your wires and add a flat outlet cover.



HOW TO: INSTALL

INSTRUCTIONS FOR INSTALLING FRAME

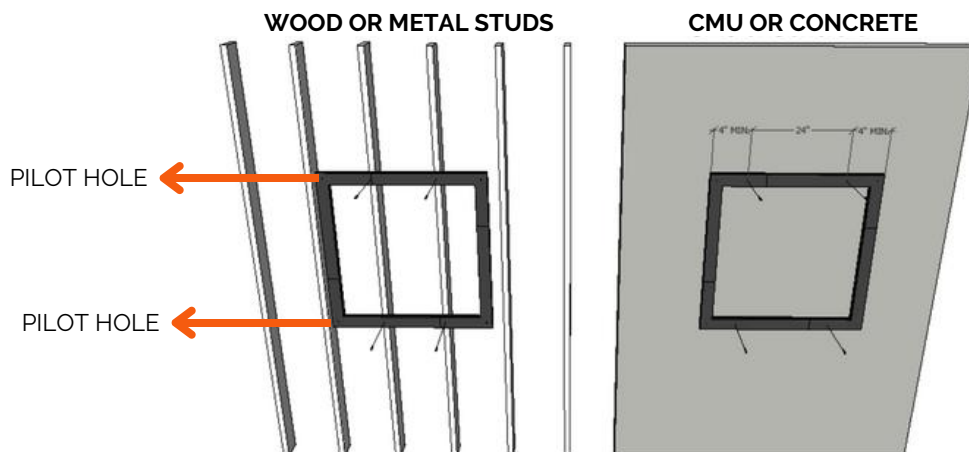

CENTER OF STUD REQUIRED

ALL FRAMES ARE REQUIRED TO ATTACH TO TWO STUDS MINIMUM WITH TWO SPECIFIED STRUCTURAL SCREWS INTO THE CENTER OF EACH STUD.

INSTRUCTIONS FOR ATTACHING FRAME

STEP 1. FIND AND MARK WALL STUDS (FOR WOOD OR METAL STUDS)

- Determine the area on your wall in which you want to mount your Climbing Panels.
- Using a stud finder, locate and mark all studs in the designated climbing area. Ensure to mark the **center** of each stud.

STEP 2. MOUNT THE FRAME

- Frames allow the Explorer Climbing Panel to be mounted anywhere on your wall. First determine your starting panel in your designated climbing area.
- Bring frame up to the wall at your starting position and ensure that the top and bottom edges of the frame cross at least two studs. Level the frame if desired, or mark your desired orientation.
- Centering your screw (up and down) on the frame, start by screwing the top of the frame into the center of each stud you have marked. Use specified fasteners described on the previous pages for your wall/stud type.
- Avoid screwing the frame to the wall at the pilot holes on the frame. This is where the Explorer Panel will be screwed into the frame (see diagram on next page).
- Finish attaching the frame by screwing the bottom of the frame into the same studs as above. Ensure you are screwing into the center of the studs.
- **Repeat the process for each frame.**
- For CMU and concrete walls, use the specified fasteners called out on previous pages. Use a minimum of four (4) fasteners - two (2) on the top and two (2) on the bottom. Space fasteners 24" on-center.

HOW TO: INSTALL

ATTACHING PANELS TO FRAME

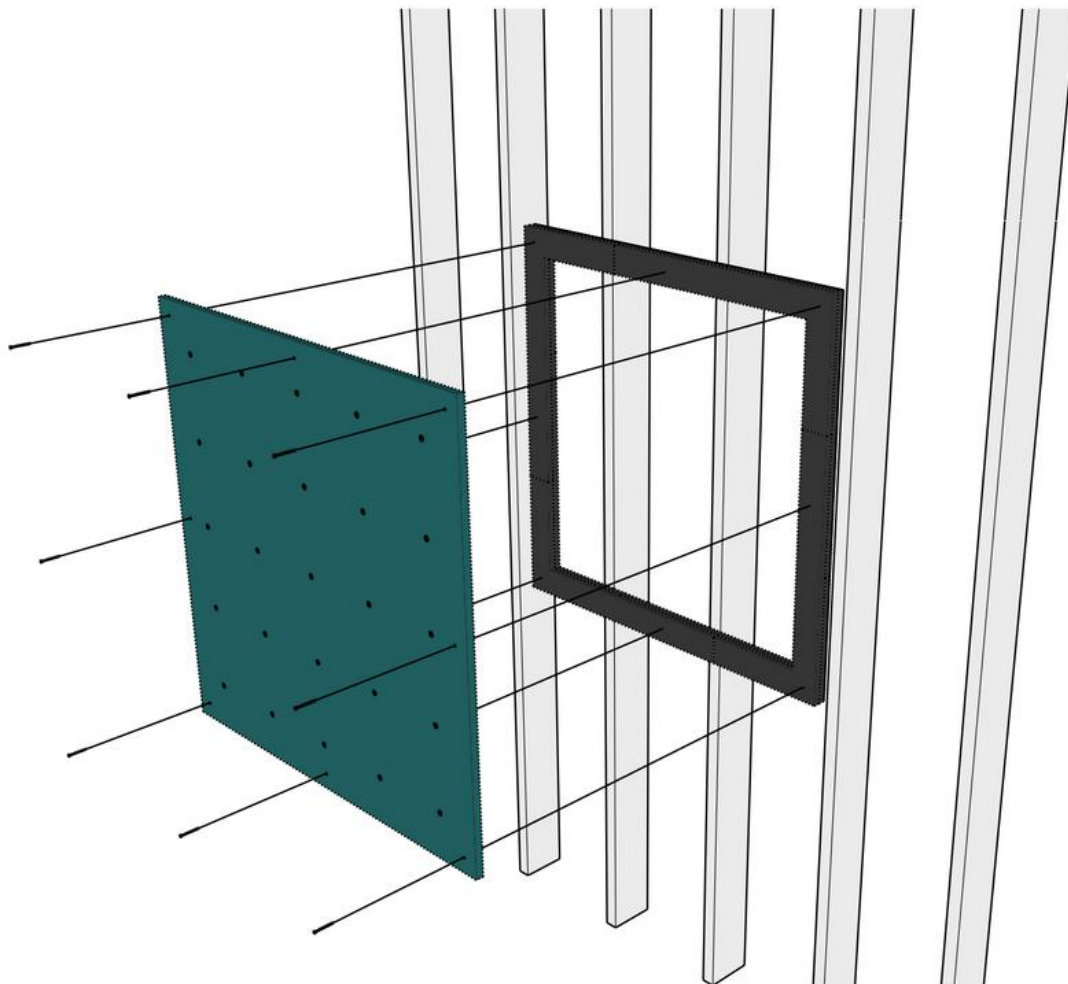

INSTRUCTIONS FOR ATTACHING EXPLORER PANEL TO FRAME

- Bring an Explorer Panel up to the frame. Center the panel onto the frame in all directions.
- Starting with the top-middle pilot hole on the panel, use a provided Panel Connector Screw and screw into the frame.
- Ensuring the panel is still centered on the frame, proceed to screw in the remaining Panel Connector Screws into the frame. Use the pilot holes present on the panel.
- Ensure all Panel Connector Screws are sufficiently tight and that all pan-heads are flush with the surface of the panel.
- Repeat the process for each remaining panel.

FAQ



FREQUENTLY ASKED QUESTIONS

DIY INSTALLATION

DO I NEED A CONTRACTOR TO INSTALL THESE?

The grOH! Shop recommends only DIY-friendly products anyone can successfully install. We recommend that an experienced, licensed, and insured contractor install your gross motor features. Whomever installs this product should explicitly follow directions laid out in this document.

WHAT TOOLS DO I NEED TO INSTALL? WHAT DOES MY WALL NEED TO BE MADE OF? DO I NEED TO BUY SCREWS?

A drill, level, and stud finder are required for install. Panels can be installed on CMU, Concrete, or studs. You may need to buy screws depending on the type of panel you've purchased--see your install instructions for details. PANELS ARE NOT APPROVED FOR OUTDOOR USE. You CANNOT install to brick or rock veneer.

CAN I CUT THE PANELS?

No, you CANNOT cut an Explorer Panel.

PANELS

WHAT IS THE TEXTURE ON THE PANELS?

The texture is grippy and slightly rough. We use a sand mix in the paint to create a climbing surface suitable to create friction for climbing shoes.

HOW MANY T-NUTS ARE THERE PER PANEL?

T-nuts are the pre-drilled holes with hardware where you can mount bolt-on handholds, and indicate the maximum number of handholds you can fit on a panel.

- Explorer Panel - 5

FREQUENTLY ASKED QUESTIONS

FLOORING

DO I NEED PADS ON THE FLOOR?

We always recommend floor protection. Check out our [FLOORING OPTIONS](#).

IS THERE A FALL SPACE REQUIREMENT FOR THE CLIMBING PANELS?

The grOH! Shop recommends a 6' (six foot) minimum perimeter around the installed panels for maximum falling or dismounting clearance.

WHAT SHOULD I GET?

For walls less than 10' bouldering (no rope, free climbing), safety mats are sufficient. Safety mats are sold separately and available in The grOH! Shop for purchase!

MAINTENANCE

DO I NEED TO DO ANYTHING TO TAKE CARE OF THE PANELS?

Our wall panels are very low maintenance. Any dirt can be wiped off with a damp cloth. Also, climbing holds from The grOH! Shop are dishwasher safe! T-nuts may strip or come loose over time and are easily replaced.

HANDHOLDS

DO HANDHOLDS COME WITH THE PANELS?

No, handholds are ordered separately so you can get the type of holds that best suit your needs!

HOW MANY HANDHOLDS SHOULD I BUY?

The grOH! Shop recommends 1 pack of 15 holds per TWO Explorer Panels. This creates paths suitable for all skill levels! The grOH! Shop sells holds in packs of 15, so there are multiple options for different climbing abilities.

HOW DO YOU PUT THEM ON AND WHERE DO THEY GO?

The holds bolt onto the panels with a large allen wrench. They can be placed wherever is comfortable.

FREQUENTLY ASKED QUESTIONS

SHIPPING

PANELS ARE SHIPPED VIA FREIGHT.

FREIGHT DELIVERIES ARE VERY DIFFERENT FROM UPS, FEDEX, OR USPS.

It is CRITICAL that you provide groH! with the an accurate PHONE NUMBER of the responsible adult who will be ONSITE to receive the shipment. *If you are unsure if you have provided the correct number, please let us know at shop@grohplayrooms.com.*

- The freight carrier will call the listed number directly to arrange delivery. We all want to avoid unknown calls, but the carrier will NOT attempt delivery without an appointment. Additional storage fees may be incurred if the products are in the carrier's dispersement location for too long (with or without a delivery appointment).
- The driver will remove the pallet from the truck and put it on the ground next to the truck.
- Inspect the outside of the package BEFORE you open it and take photos if you see any damage. Send the photos and details to shop@grohplayrooms.com immediately.
- One or more people need to be onsite to unpack the package with the panels and carry the panels to their final destination.
- Inspect the panels as you unpack them and if you see and damage, take photos of the damage and send the photos and details to shop@grohplayrooms.com immediately.
- Be advised the pallet will NOT be hauled away; it is the customer's responsibility to dispose of or reuse.

WHEN WILL MY PANELS SHIP?

Climbing Panels are made to order. Lead times can vary, but on average ship 4-5 weeks after the order is placed, and then shipping can take up to a week.

IS THERE AN OPTION OTHER THAN LTL FREIGHT TO SHIP MY PANELS?

All of our panels must ship via LTL freight. They ship on pallets and are large and heavy. We do not currently have a different option.

I ORDERED PANELS AND HOLDS. WILL THEY ALL COME TOGETHER?

Handholds ship separately, typically UPS ground, and will **not** be included in your panel's freight delivery. Lead times can vary, but on average ship 2 weeks after the order is placed, and then shipping can take up to a week depending on your location. Holds will ship upon completion so you will most likely receive your holds before your panels.

HOW IS IT DELIVERED? HOW MUCH DO THEY WEIGH?

Panels arrive on a pallet. The freight carrier will bring the delivery to your home or business and place the delivered pallets on the ground by the truck. It is the responsibility of the customer to retrieve the panels from there. You will need to be onsite to receive the panels. They cannot be left on your curb or driveway without you. We require the phone number for a responsible adult on location where the delivery is to be received. Additional fees may apply if the freight carrier isn't able to reach the person on location.

FAQ



FREQUENTLY ASKED QUESTIONS

PAINTING MY PANELS

WHAT TYPE OF PAINT DO I USE?

The paint brand is up to you! We recommend Floor and Patio, Low Sheen Paint for the climbing panels. Please note that with every layer of paint, the factory applied texture will begin to diminish.



Please be mindful of the T-Nuts and Paint. Use painters' tape or foam earplugs to make sure paint does not get in the threading of the T-Nuts.

FINAL NOTE!



TAKE CARE TO DISPOSE OF ALL MATERIALS IN A RESPONSIBLE MANNER. RECYCLE ALL PACKAGING MATERIALS WHEN POSSIBLE. KEEP ALL MATERIALS AWAY FROM YOUNG CHILDREN.

ELEVATE YOUR KIDDO'S PLAY (LITERALLY!)

Your climbing panels will revolutionize your kiddos' playtime! Gross motor play is vital to proper development!



INTERESTED IN A GROH! MURAL?

Enjoy a signature grOH! mural on your walls, ceiling, climbing panels, or anywhere you like! Check out all of our murals at shopgrohplayrooms.com!



SHARE PHOTOS WITH US!

Please share photos! We love to see how your space has transformed!

Don't worry, we won't share photos without your written consent!



CONTACT US

shop@grohplayrooms.com

FIND MORE RESOURCES AT

www.shopgrohplayrooms.com